



FOR LEASE
Somersville Town Center
 2550 Somersville Road, Antioch, CA



PROPERTY PROFILE

Size: ±49,412 SF (Divisible to ±20,000 SF)
 Price: Please Contact Broker for Pricing

PROPERTY HIGHLIGHTS

- Anchor space adjacent to brand new 24 Hour Fitness club
- High ceilings which can support any use
- Regional accessibility
- Ample parking
- Price: Inquire with Broker

DEMOGRAPHICS

	1-mile	2-mile	3-mile
Population	16,793	50,772	86,274
Daytime Population	11,710	22,049	32,759
Median HHI	\$42,069	\$51,775	\$52,551

DEMOGRAPHICS

Hwy 4 at Somersville Rd. 241,000 ADT
 Somersville Rd. at Buchanan Rd. 30,940 ADT

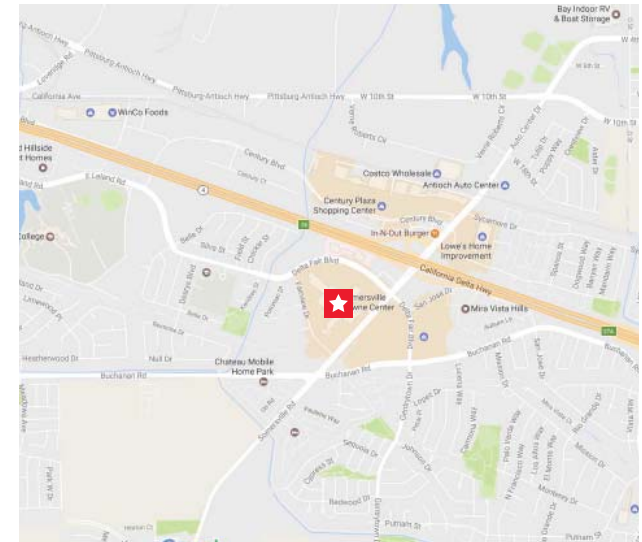

James Chung
 Executive Managing Director
 Managing Principal, West Region Retail
 +1 408 436 3630
 james.chung@cushwake.com
 LIC #01408190

Mike Costa
 Senior Director
 +1 408 436 3660
 mike.costa@cushwake.com
 LIC #00415216

300 Santana Row, Fifth Floor
 San Jose, CA 95128
 main +1 408 615 3400
 fax +1 408 615 4444
cushmanwakefield.com

Cushman & Wakefield Copyright 2017. No warranty or representation, express or implied, is made to the accuracy or completeness of the information contained herein, and same is submitted subject to errors, omissions, change of price, rental or other conditions, withdrawal without notice, and to any special listing conditions imposed by the property owner(s). As applicable, we make no representation as to the condition of the property (or properties) in question.

SPACE PLAN

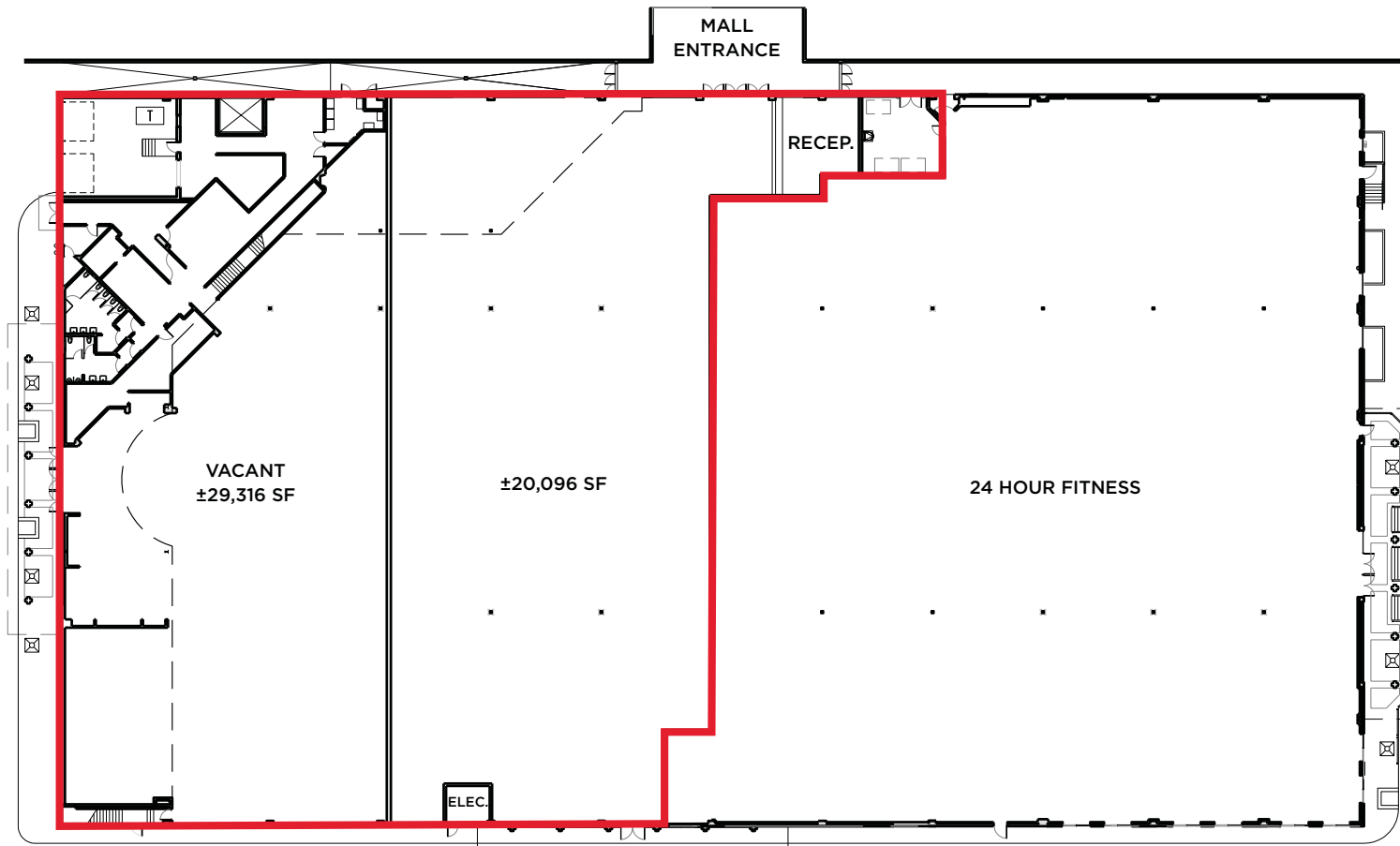

James Chung
Executive Managing Director
Managing Principal, West Region Retail
+1 408 436 3630
james.chung@cushwake.com
LIC #01408190

Mike Costa
Senior Director
+1 408 436 3660
mike.costa@cushwake.com
LIC #00415216

300 Santana Row, Fifth Floor
San Jose, CA 95128
main +1 408 615 3400
fax +1 408 615 4444
cushmanwakefield.com

POTENTIAL SPACE PLAN - OPTION A

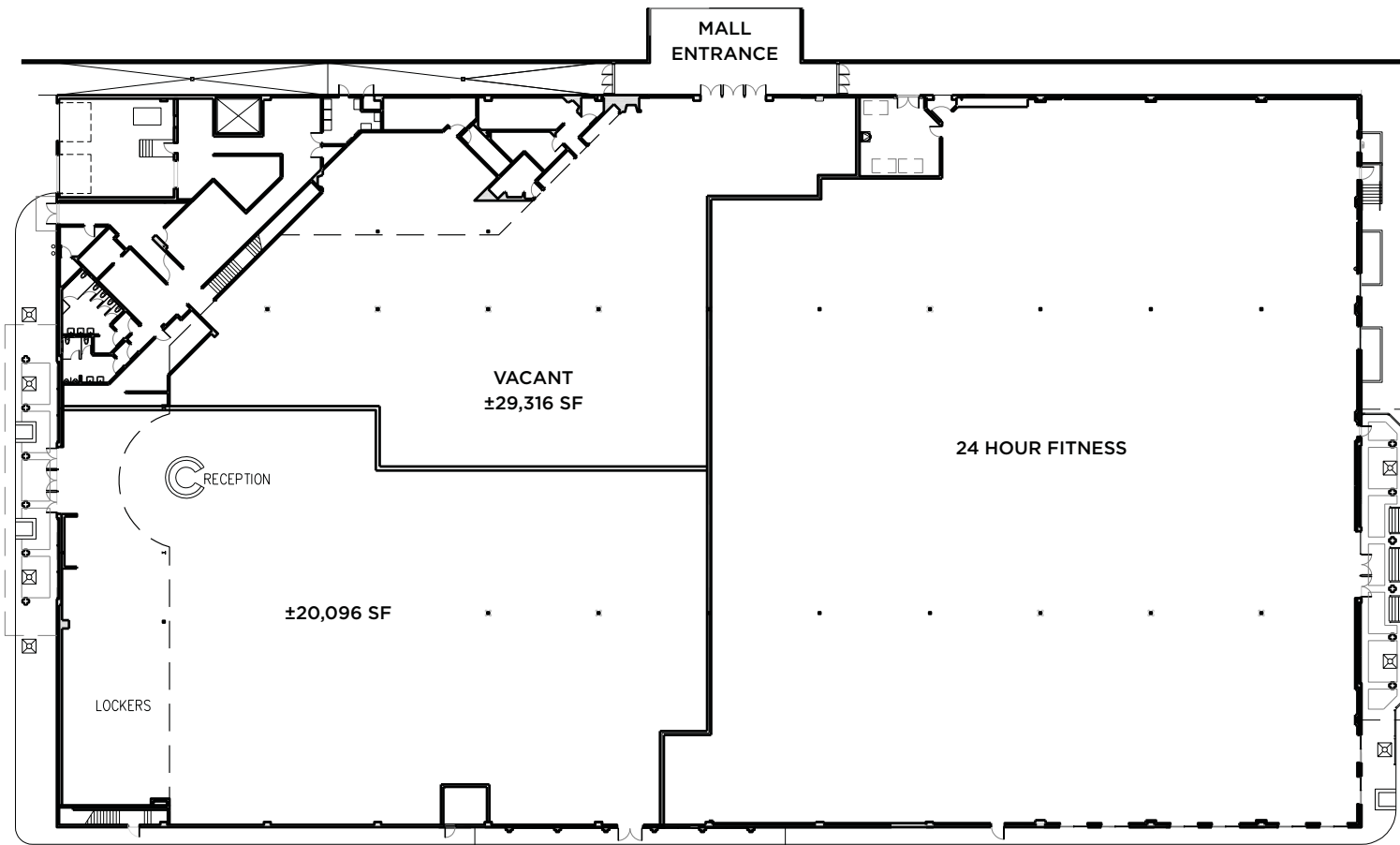

James Chung
Executive Managing Director
Managing Principal, West Region Retail
+1 408 436 3630
james.chung@cushwake.com
LIC #01408190

Mike Costa
Senior Director
+1 408 436 3660
mike.costa@cushwake.com
LIC #00415216

POTENTIAL SPACE PLAN - OPTION B

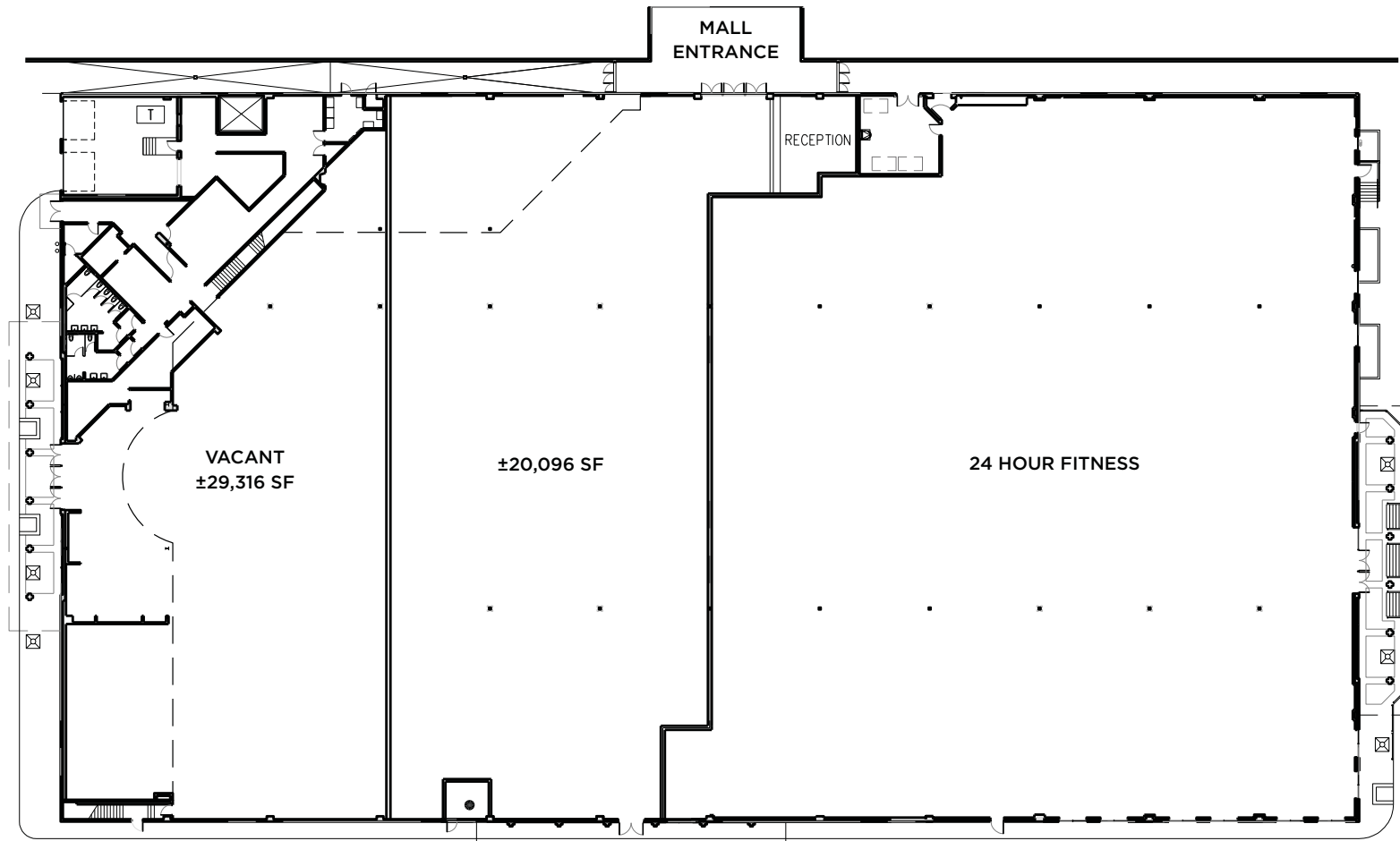

James Chung
Executive Managing Director
Managing Principal, West Region Retail
+1 408 436 3630
james.chung@cushwake.com
LIC #01408190

Mike Costa
Senior Director
+1 408 436 3660
mike.costa@cushwake.com
LIC #00415216

300 Santana Row, Fifth Floor
San Jose, CA 95128
main +1 408 615 3400
fax +1 408 615 4444
cushmanwakefield.com

AMENITIES MAP



James Chung
 Executive Managing Director
 Managing Principal, West Region Retail
 +1 408 436 3630
 james.chung@cushwake.com
 LIC #01408190

Mike Costa
 Senior Director
 +1 408 436 3660
 mike.costa@cushwake.com
 LIC #00415216

300 Santana Row, Fifth Floor
 San Jose, CA 95128
 main +1 408 615 3400
 fax +1 408 615 4444
cushmanwakefield.com

SURROUNDING AMENITIES MAP



James Chung
Executive Managing Director
Managing Principal, West Region Retail
+1 408 436 3630
james.chung@cushwake.com
LIC #01408190

Mike Costa
Senior Director
+1 408 436 3660
mike.costa@cushwake.com
LIC #00415216

300 Santana Row, Fifth Floor
San Jose, CA 95128
main +1 408 615 3400
fax +1 408 615 4444
cushmanwakefield.com